



PRODUCT DESCRIPTION:

Designed to fit any ceiling surface 6.0" – 7.4" (153-190mm). Suspended and hanging for other types of ceilings such as art galleries, homes, schools, offices, hotels, restaurants, retail stores and other commercial or industrial applications.

FEATURES:

- Adjustable wattage (10W / 15W / 22W)
- Adjustable CCT (3,000K / 4,000K / 5,000K)
- For retrofit or new construction installation
- Easy fit installation – spring action housing clips
- Universal housing compatibility
- Low maintenance
- No mercury
- Recyclable

DIMENSIONS:

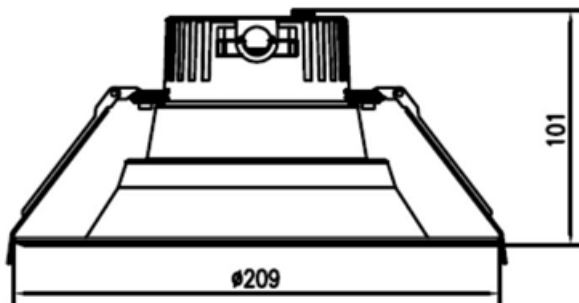

6" Downlight Multi Watt & Multi CCT CDL6





6" Downlight Multi Wattage & Multi CCT

SPECIFICATIONS:

		Specs		
Model	CDL6			
Input Power	10W	15W	22W	
Lumens	900lm	1,350lm	1,750lm	
CRI	90+			
CCT	3000K/4000K/5000K			
Equivalent Watts	100W			
Dimming	0-10V			
IP Rating	Dry & Damp Locations			
Beam Angle	120 Degrees			
Input Voltage	110-277V			
Power Factor	0.9+			
Lens	Frosted Polycarbonate			
Mounting	Recessed with Spring Clips			
Certification	ETL, EnergyStar			
Ambient	-10°F to 110°F			
Warranty	5 Years			

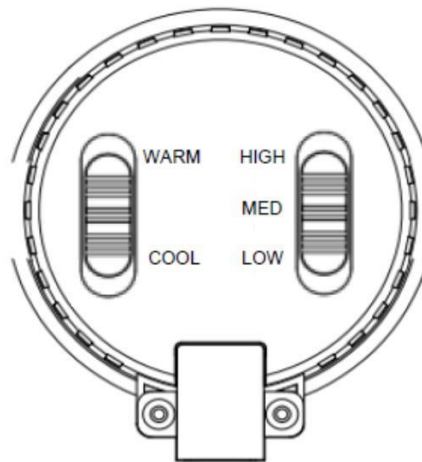

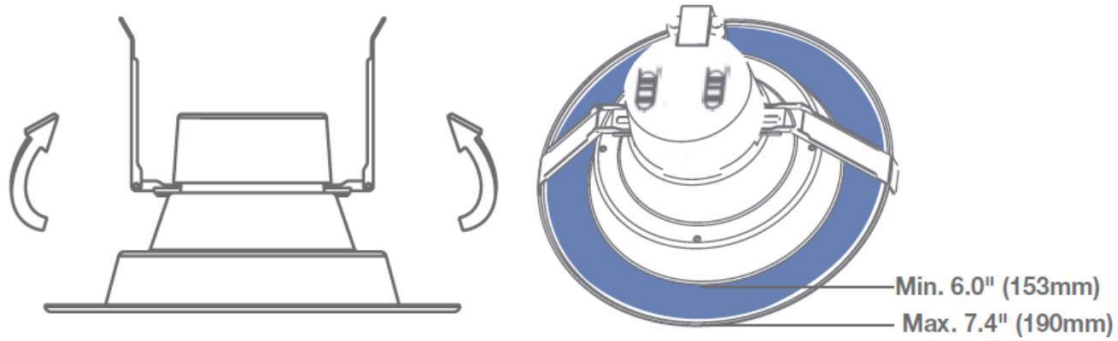

Retrofit Installation



Attach safety clip



Bypass ballast & wire to j-box

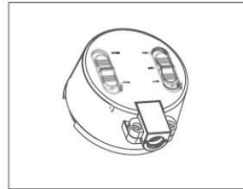

Adjust lumens or color to desired output

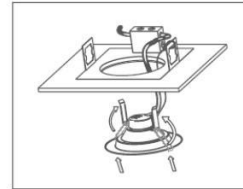

Push clips up & install into fixture

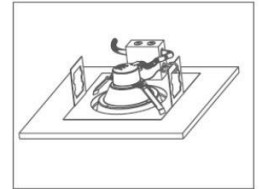

Ensure fixture is flush. Installation is complete

New Construction Installation

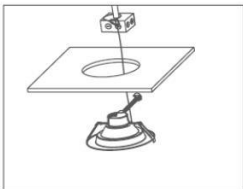

Attach safety clip

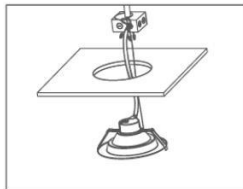

Wire to j-box

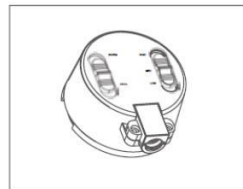

Adjust lumens or color to desired output

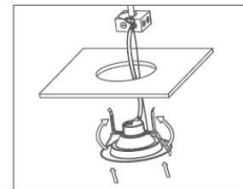

Push clips up & install into opening

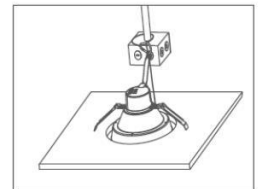

Ensure fixture is flush. Installation is complete